

产品规格书

PRODUCT APPROVAL SHEET

敬请承认如下之形式规格书:

客户名称 CUSTOMER: _____	
贵公司制品名 CUSTOMER PN: _____	本公司制品名: 连接座 PRODUCT PN: Connecting seat
贵公司规格 APPROVAL DAT: _____	本公司规格: PRODUCT CODE: OMT-SC173
客户料号 Customer NO: _____	本公司规格书编号: PRODUCT DRAWING NO: 20180512-3

<input type="checkbox"/> 新品承认 NEW APPROVE <input type="checkbox"/> 规格变更再承认 CHANGE CODE APPROVE AGAIN <input type="checkbox"/> 材料变更再承认 CHANGE MATERIAL APPROVE AGAIN	APPROVAL 批准	CHECK 审核	DESIGN 设计:
	DATE: _____	DATE: _____	DATE: _____

贵公司承认栏

APPROVAL SIGNATURES

印章

请于_____年_____月_____日前承认返回

日期 DATE: _____

PLEASE RETURN TO ADMIT XUNIANRURI

地 址: 中国浙江省乐清市淡溪第二工业区
 销售热线: 86-577-62395000 62395001 62395002
 传 真: 86-577-62395006 62395008
 邮 编: 325608
 电子邮件: omten@omten.com omten@163.com
 网 址: http://www.omten.com



ISO9001 ISO14001
认证企业

代号: OMT-CS173 CODE No: OMT-CS173		名称: 连接座 NAME: Connecting seat	页码: 1/4 PAGE NO : 1/4
<p>一 使用环境条件: 温度: -25~+70℃: 相对湿度 95%以下: 额定电压: 30V (DC): 额定电流: 1A。 Environmental Condition of utilization: Temperature: -25~+70℃: Relative humidity: below95% Rated Voltage: 30V (DC) Rated Current : 1 A</p> <p>二: 规格 Specifications:</p>			
序号 Order	项目 Item	试验条件 Experimental Condition	指标 Target
1	外观 Outward Appearance	目测 Visual Measurement	金属表面应清洁、无锈蚀和镀层起脱现象, 塑料壳应无飞边、裂纹、损伤、凹凸不平。 Metal surface should be smooth and not be corroded by rust.Plating should not crease or peel off.Plastic casing should not be uneven, crude or have any cracks or damage
2	尺寸 Dimensions	开关安装尺寸、配合尺寸按本产品图纸及零部件图要求, Socket installation size,coordination size should be in accordance with the requirements of the drawings of this product.	按图纸尺寸以及公差要求。 According to the size of the drawing and folerance.
3	耐电压 Voltage Resistance	常态: 50HZ AC 500V 1分钟 Normally: 50HZ AC 500V 1min	各导电部份之间的绝缘, 应能承受试验电压的作用而无击穿。 The insulation of different parts conducting electricity should bear the function of experiment voltage and there are no punctures on it.

代号: OMT-CS173 CODE No: OMT-CS173		名称: 连接座 NAME: Connecting seat	页码: 2 / 4 PAGE NO : 2 / 4
序号 or der	项目 <u>Item</u>	试验条件 <u>Experimental Condition</u>	指标 <u>Target</u>
4	绝缘电阻 Insulation Resistance	试验电压: D C 500V ± 15 V Experiemeht Voltage:DC 500V ± 15V	常态:应 ≥ 100M Ω Normally: ≥ 100M Ω
5	接触电阻 Contact Resistance	用两倍的动作力作静负载施加于按钮的中心, 并用 1 千赫小电流接触电阻仪测量。 Applying a static load twice the actuating force to the center of the stem, measurements shall be made with a 1 kHz small-current contact resistance meter.	常态: 电池盒正/负极脚与行程开关脚之间电阻最大 260m Ω 电池盒负极弹簧与行程开关脚之间电阻最大 1 Ω 寿命试验后: 电池盒负极脚与行程开关脚之间电阻最大 1 Ω 电池盒负极弹簧与行程开关脚之间电阻最大 2 Ω
6	动作力 Insertion and Pulling out Forces	用标准头,沿按钮轴线方向进行测量。 The force is measured when the inserting or pulling out is done in the direction of the aperture axis with a standard plug .	根据使用要求制作 动作力在 3N-35N 范围内 Operating Force 3N-35N
7	焊接条件 Conditions for soldering	波峰焊条件 Wave soldering conditions 预热: 在 P.W.B(印刷线路板)进入焊接设备后, 2 ± 0.3 分钟内铜箔表面要达到 180℃。 Preheat: Temperature on the copper foil surface should reach 180℃, 2 ± 0.3 minutes after The P .W. B entered into the soldering equipment 焊接温度: 在 P.W.B (印刷线路板)进入焊接温区 20 秒内, 铜箔表面达到峰值温度 245℃。 Soldering heat: Temperature on the copper foil surface should reach the peak temperature of 245 °C within 20 seconds after the P.W.B entered into soldering heat zone.	外 观: 应符合第 1 条规定。 绝缘电阻: 应符合第 4 条规定。 Outward appearance conforms to the stipulation of Article 1. Insulation resistance conforms to the stipulation of Article 4.

代号: OMT-CS173 CODE No: OMT-CS173		名称: 连接座 NAME: Connecting seat	页码: 3 / 4 PAGE NO : 3 / 4
序号 Order	项目 Item	试验条件 Experimental Condition	指标 Target
8	可焊性 Heat and Solder Resistance	在焊锡温度: 250°C ± 10°C 的焊锡槽中, 浸渍时间: 3 ± 1 秒后, 目测。 Soldering temperature :250°C ± 10°C, Soaking time in tin soldering groove: 3 ± 1S, Visual measurement.	上锡面积达 95%, 并且光滑, 平整。 Tin soldering area is up to 95%. The surface is smooth and even.
9	Operating Life 动作寿命	Measurements shall be made following the test set forth below: (1) Rate of operation : 45 operations per minute 动作频率: 45 次/每分。 (2) Depression 动作力: 35N Max (3) Cycles of operation 动作次数 1,000 次。	Vertical plug 垂直拔插 action force attenuation rate was 15 % of the initial value 动作力衰减率为初始值的 15% 左右。
10	合格批判定 Judgement of Qualified Product Batch	从提交批产品中, 按 GB 2828.1-2003 “逐批检查计数抽样程序及抽样表” 中一般检查水平 II, 一次正常检查抽样方案, 进行验收。 The presented batch of products is checked before acceptance according to the plan of a normal and general sample check up. It is in the light of “Checking up every batch and counting the number” is sampling procedure of CB2828’s inspection level.+	合格质量日水平 AQL 值为: 1.0。 The AQL value of qualified products is 1.0

代号: OMT-CS173 CODE No: OMT-CS173		名称: 连接座 NAME: Connecting seat	页码: 4 / 4 PAGE NO: 4 / 4
序号 Order	项目 <u>Item</u>	试验条件 <u>Experimental Condition</u>	指标 <u>Target</u>
11	包装 Packing	<p>开关用塑料袋或硬纸盒包装, 装有产品的包装袋(包装盒)应装在干燥、防尘包装箱内, 箱内应有装箱清单。</p> <p>The sockets are packed in a plastic bag or a car-board box, which is placed into a damp-proof and dust-proof packing box with a shipping bill.</p>	<p>装箱单及包装盒, 包装箱应注明产品名称、型号(代号)、数量以及制造厂名称、日期、检验印章。</p> <p>The shipping bill, packing box and the car-board box should be impressed with the product name, type, quantity and the manufacture, production date and inspection stamp.</p>
12	运输 Shipment	<p>包装成箱的产品, 不可重压、倒置、用任何运输工具运送。</p> <p>Products packed in a box can not be placed upside down or pressed with heavy objects on it, They can be shipped by any means of transport.</p>	<p>应在避免雨雪淋袭、浸湿的条件下。</p> <p>Products should be shipped under the condition of being free from rain or snow in a dry place.</p>
13	贮存 Storage	<p>包装成箱未开封的产品, 应在环境温度-10~+40℃相对湿度在80%以下, 周围空气中无酸性, 碱性和其它腐蚀气体的仓库里贮存。</p> <p>The environment temperature of products packed in an unopened box is -10~+40℃. Its relative humidity is below 80%. Keep in a warehouse without acid, alkaline and corrosive air around it.</p>	<p>贮存期自生产日期起半年。</p> <p>Storage period is half a year after production date.</p>

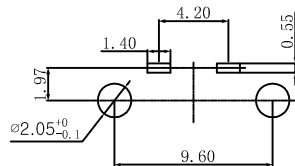
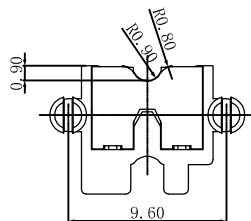
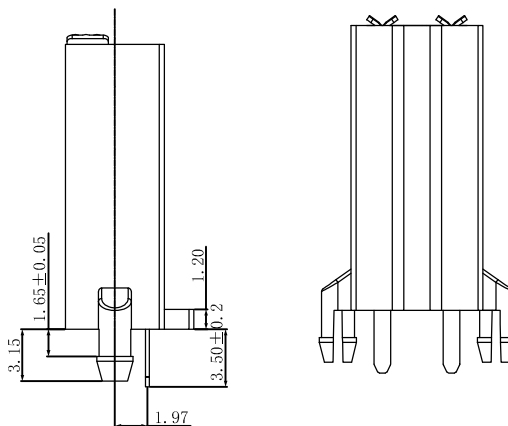
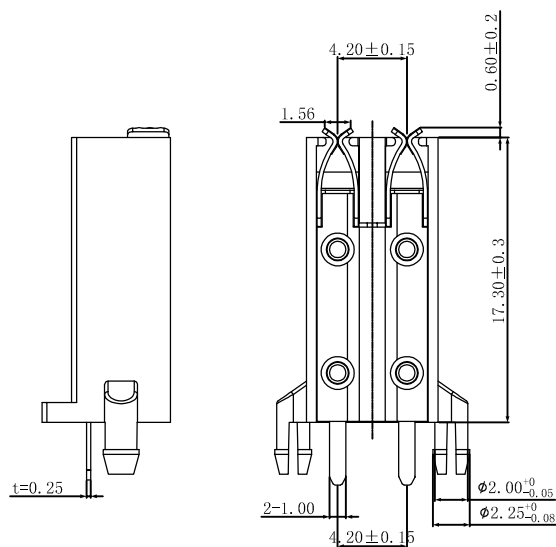
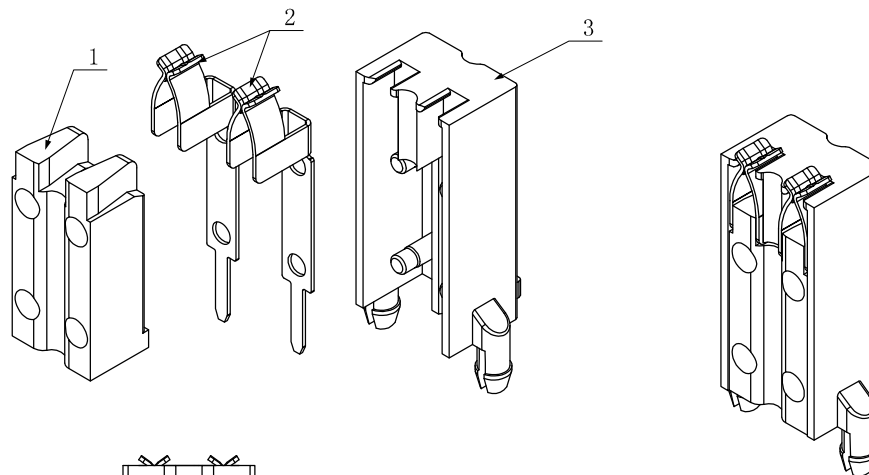
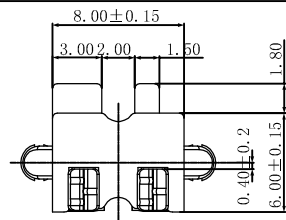

线路板开孔尺寸

技术参数:

1. 额定负载: DC 30V 1A.

2. 接触电阻: DC 5V 1A

电池盒正/负级脚与行程开关脚之间电阻最大260mΩ.

电池盒负级弹簧与行程开关脚之间电阻最大1Ω.

3. 绝缘电阻: DC 500V 100MΩ(min)

4. 耐压: AC 500V 1分钟 (极与极)

5. 拔插力: 3N-35N

6. 寿命: ≥1000次.

3	基座	1	PA66 30%增强	黑色	—
2	接触脚	2	合金磷铜	镀镍	C5191 0.3um Min
1	压盖	1	尼龙	黑色	—
序号 NO.	名称 DESCRIPTION	数量 Q'TY	材料 MATERIAL	颜色 COLOR	备注 REMARK

omten® 浙江欧麦特电子
WWW.omten.com

品名 ITEM NO.	连接座				
料號 PART NO.	OMT-CS173				
圖號 DRAWING NO.	B	OMT3. 610. 839			
狀態碼					
SCALE		UNIT	mm	A4	☉

					Angle	±0.2°	DESIGN	设计		
					30~	±0.3	CHECH	校对		
			改内扣, 防止脚位卡死	②	10~30	±0.2	VERIFY	审核		
	B	2017. 05. 16	改小间隙	①	~ 10	±0.15	APPROVAL	批准		
工程變更通知單 ECN(DCN) NO.	版次 REV	日期 DATE	說明 DESCRIPTION	改變 CHANGE	承認 APPRO.	未注公差GENERAL TOLERANCE UNLESS OTHERWISE NOTED				